

## STATUS OF LANDSCAPE ARCHITECTURE IN KENYA

**History of the Landscape Architects Chapter and Her Influence within Architectural Association of Kenya (AAK)**

The Landscape Architects Chapter of Kenya (LACK) was formed in 1989 by an amendment of the AAK constitution. At the time, there were only about 7 members, most of whom were architects and planners with some post graduate training/interest in undertaking landscape commissions. Since then the numbers have grown to about 200, with the introduction of the Landscape Architecture program at the Jomo Kenyatta University of Agriculture and Technology in 1999.

The AAK constitution guarantees 2 Landscape Architects to sit at the AAK governing council, the decision making organ of AAK. The Chapter has autonomy to make independent decisions on its membership, its calendar and budgets. However, due to relatively lower numbers, Association-wide decisions tend to be carried by the more established chapters of Architects and Quantity Surveyors who have majority members.

**Recognition of the Profession**

Landscape architecture is not currently recognized under the law in Kenya. However the profession has grown in stature over the years. Through structured advocacy with procuring entities our members are consistently being commissioned to undertake public sector projects. Others are employed by both National and county governments.

There is a proposed Scheme of Service for Landscape Architects currently under consideration the Public Service Commission. There is a lot that still needs to be done though to mainstream the profession and professionals in the country.

**Regulation of the Profession**

As Indicated above, there is no legal regulation of the profession yet. However the Landscape Architects Chapter registers both graduate and corporate landscape architects. To move from graduate membership to corporate membership, a member has to undertake the Landscape Architects' Corporate Exams (LACE) administered by the chapter. We are constantly in touch with procuring entities to insist on engaging only registered professionals.

There is currently an effort by the AAK to lobby for a Built Environment Professionals bill which if implemented would see Landscape Architecture recognized and regulated. This new process is unique in that it's not government driven unlike all previous efforts.

by Hosea Omole



Private residence by Landscape Architect Ambrose Ofafa of Ecoarch Solutions Ltd. (Nairobi)



This Month IFLA-Africa News comes from

**Hosea Omole**

President

email: [hosea@lancad.co.ke](mailto:hosea@lancad.co.ke)

[www.aak.or.ke/aak-chapters/landscape-architects](http://www.aak.or.ke/aak-chapters/landscape-architects)



Landscape Architects Chapter Architectural Association of Kenya (LACK)

**Next IFLA-AFRICA Issue from Tunisia**

TALAE will organize in 2019 the 6th African Symposium **The Landscape, Landscape Architects and Sustainable cities**



Residential Landscape by Landscape Architect John Gikundi of Prolak Architects, Nairobi, Kenya.



<https://web.facebook.com/IFLA.Africa/>



**Department Of Landscape Architecture Jomo Kenyatta University of Agriculture And Technology School of Architecture And Building Sciences**

The department of Landscape Architecture is domiciled in the School of Architecture and Building Sciences in Jomo Kenyatta University of Agriculture and Technology. Established in 2000/2001, the department admitted the first students in the year 2000 for a Bachelor in Landscape Architecture undergraduate program undertaken in four years. The current student population stands at 220 for the Bachelor in Landscape Architecture program. The Bachelor of Landscape Architecture program is currently under review in order to align it to the National goals, the Big Four Plan and the university strategic plan 2018-2022.



Dr. Esther Katile, PhD.  
Department Chairperson

Critical in this review is continuous feedback from the industry and other related stakeholders who include public sector, private sector, NGOs, development partners and research institutions.

**The reviewed Bachelor of Landscape program is expected to:**

- i. Enhance relevance to Industry and entrepreneurial culture;
- ii. Undertake demand driven and innovative research in collaboration with other stakeholders;
- iii. Develop, transfer and commercialize innovative products.

Other accredited programs by CUE (Commission of Higher education) in the Department include:

- I. Masters in Landscape Architecture.
- II. Masters in Environmental Planning and Development.

**Main objectives of the department:**

- a) Train and equip Landscape Architecture students with necessary skills for design, planning and management of Landscapes for social economic transformation;
- b) Undertake research and collaboration with relevant stakeholders to enhance socioeconomic development;
- c) Develop, transfer and commercialize innovations with relevant stakeholders.

**Students' Portfolio**

The Bachelor of Landscape Architecture program is a four-year course that culminates with a students' projects' portfolio presentation at the end of each academic year. The exercise which is normally carried out by a panel of both internal and external examiners was this year privileged to have Graham Young (Senior Lecturer and Landscape Architect at the Department of Architecture - University of Pretoria) and Dr. Samuel Maina (School of Design – University of Nairobi). Here are the highlights of the presentation:



External Examiners Graham Young (front) and Dr. Samuel Maina during a presentation by Lilian Otari



**IFLA**

INTERNATIONAL FEDERATION OF LANDSCAPE ARCHITECTS

World Events : <http://iflaonline.org/events/>



Left to Right: Students Kasisa, Isanda and Sharon outside Technology House which houses the department



Dancun Abuor preparing for presentation



**Sustainability of Social-Ecological Systems: the Nexus between Water, Energy and Food.**

BY: Universitat Autònoma de Barcelona

You will learn to see your community or country as a complex social-ecological system and to describe its water, energy and food metabolism in the form of a pattern, as well as to map the categories of social actors.

**Link**

<https://www.coursera.org/learn/sustainability-social-ecological-systems>





Class of 2018 Students in their working studio

**Recent Events**

**Community Participation at JKUAT.**

The department participated in this year's tree planting day by sponsoring and planting of tree seedlings within the university. We hope to increase our level participation by inviting more stakeholders to partake in the event in future.



**Departmental Fun Day**

This was organized by the Landscape Architecture Students Association (LASA). It was a fun-filled day whose theme was to exercise the physical muscles away from design studios!!! Students battled it out in different field games with support from both academic and non-academic departmental staff. Year two was the overall winner; congratulations to them. We look forward to the next year's event. Let the preparations begin!

**Active Research by Department Members**

- The Influence of Urban Form on Climate Change Vulnerability in Nairobi. By Abuje S. J., Prof. Otoki M. B. and Dr. Mugwima N. B. (PhD).
- Evaluation of Depleted Urban Riverine Ecological Systems; Does Spatial Planning Work? By Wanza C., Prof. J.B. Njoroge and Dr.D. Karanja (PhD).
- The Influence of Spatial Characteristics on Use Levels of Urban Parks in Nairobi County. by Stella M., Prof. C. Mireriani and Dr. Makworo M. (PhD).
- Evaluation of Heritage Values in Conservation of Towns along the Kenya Uganda Railway. By ObatsaA., Prof. Munala G. and Dr. Mugwima N. B. (PhD).
- The Influence of Land Use Activities on Urban Wetlands Biodiversity in Nairobi. By C. Toroitich, Dr. Karanja D. (PhD) and Dr. Mugwima N. B. (PhD).

by Dr. Esther Katile, PhD. Department Chairperson

**Landscape Architecture Student Design**

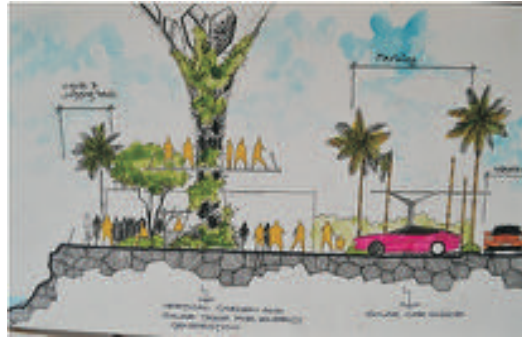

A cross-section of a proposed park by Peter Mutisya



A neighborhood planning project physical model by year two student Martha Oloo.



Department Staff members and student

**Projects by Kenyan Landscape Architects**



John Gikundi of Prolak Architects, Nairobi, Kenya.



Msasani Sports Facility Mini Golf Construction underway. By Landscape Architect Carolyn Wanza of Ecoarch Solutions Ltd. (Nairobi)



**IFLA World Congress 2018 – Singapore**

The annual congress was held in Singapore from 18-20 July 2018 at Marina Bay Sands. It concluded successfully with 1,552 attendees; a total of 15 from Africa, 10 of whom were from Kenya. It was the first time Kenya sent an admirable number of delegates. The conference was underpinning Singapore's thought-leadership and commitment in creating livable urban ecosystems anchored in biophilia. Meeting and interacting with Landscape Architects and related practitioners from around the globe was exciting and eye-opening with an infinite learning curve. There is no doubt that the team brought with it energized ideas to reinforce training and practice of the profession within our continent.



IFLA Africa delegates with President Carey Duncan



Conference break-out



**Singapore Sites, Scenes, Sounds and Scents**



Poster exhibition at the conference





**IFLA AAPME WARDS 2018 RESILIENCE BY DESIGN COMPETITION**



IFLA Africa President Carey Duncan receiving her certificate of thanks for being on the jury of the IFLA AAPME awards, from Damian Tang, IFLA APR President

**IFLA 2018 Student Design Charrette**

A total of 413 entries were presented for the student design charrette. The awards presentation took place at the Congress's welcome reception. The organisers reported that it was a strong testament to the passion and commitment of the youth in designing innovative urban environments for the future. The African region was only represented by Fritz Noel Bayong, a Cameroonian student studying in Gabon. The students did an amazing amount of work for one and a half days, but most importantly a fantastic experience! We encourage more participation by our students in future.



*Fritz Noel Bayong*



**Upcoming Events**

- ASLA 2018 – The American Society of Landscape Architects, Philadelphia, USA (19<sup>th</sup> – 22<sup>nd</sup> October, 2018).  
“African Renaissance: A continent on the rise!” a panel at the ASLA Conference in October, presented by Hitesh Mehta, Carolyne Wanza and Anthony Wain”.
- 56<sup>th</sup> IFLA WORLD COUNCIL AND CONGRESS to be held in Oslo on 18<sup>th</sup>-20<sup>th</sup> September 2019

by Carolyne Wanza

**AWARD WINNERS**



**OUTSTANDING AWARD**  
CROSSWAYS FARM VILLAGE – by CMAI South Africa



**AWARD OF EXCELLENCE: THESEN ISLAND BLUE FLAG MARINA DEVELOPMENT**CMAI – by CMAI South Africa



**AWARD OF EXCELLENCE: LUANDA BAY, Water front requalification, Angola** –by LandPlan

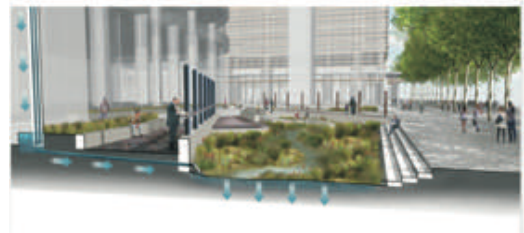

**HONORABLE MENTION: MERRIMAN SQUARE** -By Square One Landscape Architects



**HONORABLE MENTION: SAVANNAH CIRCLE, Lewa Wildlife Coservancy, UNESCO World Heritage Site, Kenya** – By The Chincol Company LTD



## Highlights from Landscape Architects in Africa and Internationally

This last month was precisely marked by brilliant projects proposed by professionals but also African landscaping students.

The HM Design office has just won, in June 2018, the ASLA Florida Award of Excellence for a project in Kenya.

IFLA Africa President along with Graham Young (Secretary General) will be attending the ILASA's biannual Conference which will be held on the 13 and 14 of August this year, in the majestic Drakensberg, includes a day of collaboration with the Land Rehabilitation Society of South Africa (LaRSSA).



View towards the thatched hotel block across a typically yellow lawn so characteristic of a South African winter



Left to Right: Graham Young and Carey Duncan representing IFLA Africa and Eamonn O'Rourke, ILASA President.

### 6th IFLA Africa Congress

Finally, We hope that during the 6th IFLA Africa Congress, which will take place in 11-12 October in Tunisia and will be organised by TALAE, under the theme The Landscape, Landscape Architects and Sustainable Cities, we will be able to discuss the possibilities of increasing the number of qualified landscape architects on the continent, by developing adequate educational opportunities.

by Sondès Zaier



An early evening winter landscape at the conference venue- the Drakensberg mountains take on an ethereal quality.



What a view to wake up to!

## LANDSCAPE ARCHITECTS QUOTES

**“You can't use up creativity. The more you use, the more you have”.**

—Maya Angelou (1928-2014)

The more you practice the better you get. Never stop sketching ideas, and working them up. You can't use up creativity!

**“You can design and create, and build the most wonderful place in the world. But it takes people to make the dream a reality”.**

-Walt Disney (1901-1966)

People more than animate the landscape. They are our ultimate clients. When we design for people we succeed in landscape architecture

By Land8: Landscape Architects Network on September 14, 2014

<https://land8.com/11-famous-quotes-that-apply-to-landscape-architecture/>



### NEWS FROM EXCO IFLA Africa PPP, Maimuna Saleh-Bala PhD

The excitement of the just concluded 55<sup>th</sup> IFLA world congress in Singapore and the ILASA's biannual conference in South Africa is still with us here at IFLA Africa as we share our experiences, presentations, information, photos and online resources with colleagues and students.

This month's EXCO section is an update as a lot of what happened in IFLA Africa had been covered extensively in the two events. We were well represented by IFLA Africa EXCOs Carey Duncan and Carolyn Wanza as well as a well-recognised entourage of colleagues and students from Kenya. The SLAN President Deborah Nenchi (Nigeria) and IFLA Africa PPP Chair Maimuna Saleh-Bala unavoidably missed the congress but made the Singapore Garden Festival which was very exciting and educative as well.



Photo from Singapore Garden Festival

### Promoting Landscape Architecture education

IFLA Africa continues to work on promoting Landscape Architecture education as well as recognition for the profession. The academic update at the international level includes the participation of five universities from Africa in the International Geodesign Collaboration (IGC) with the theme 'towards changing our global infrastructure'. Two Universities each from Kenya and Nigeria, as well as one from Ethiopia while South Africa has the status of 'keep informed'. Eighty universities worldwide are participating. Details of the collaboration which runs through to June 2019 can be found on the IGC web site <http://www.geodesigncollab.org>. The collaboration is anchored by retired Harvard GSD Professor of Landscape Architecture, Carl Steinitz and the Geodesign hub.

### (ASLA) Convention at Philadelphia

In October 2018, IFLA EXCOs Carolyn Wanza and Tunji Adejumo will join Hitesh Mehta to make presentation on landscape education in Africa at the America Society of Landscape Architects (ASLA) Convention at Philadelphia.

### Photos from Singapore Garden Festival





Still on education IFLA Africa Secretary Graham Young visited the Jomo Kenyatta University of Agriculture and Technology (JKAT) to assist in the landscape Programme take-off while Maimuna Saleh-Bala and her colleagues in Nigeria are working on the curriculum to establish Departments of Landscape Architecture in Nigeria Universities with the first, hopefully to be at the Ahmadu Bello University Zaria.

The Region is also expanding in both strength and numbers at the professional level. Individual members have joined IFLA from Niger and Ghana while awaiting enough members to enable the formation of their National Associations (NA). Botswana NA has submitted its application for IFLA membership while SLAN of Nigeria is initiating an act of parliament to give it better professional recognition. The IFLA Africa PPP now has representatives in all the seven working groups and therefore promises to be another eventful year as we join other regions in drawing a course for our future landscapes.

**Maimuna Saleh-Bala PhD**

Photos from Singapore Garden Festival



**Photos from Singapore Garden Festival**

